

## Restrained Spring Mounts with Internal Levelling//Type RMI

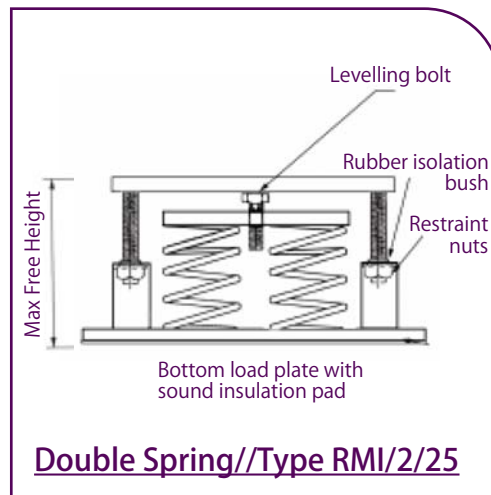

Type RMI are free standing restrained mounts with internal levelling. The springs are positioned between a steel bottom load plate, bonded to a neoprene stop pad, and a steel top load plate. The spring is held in with two drilled and tapped steel restraints.

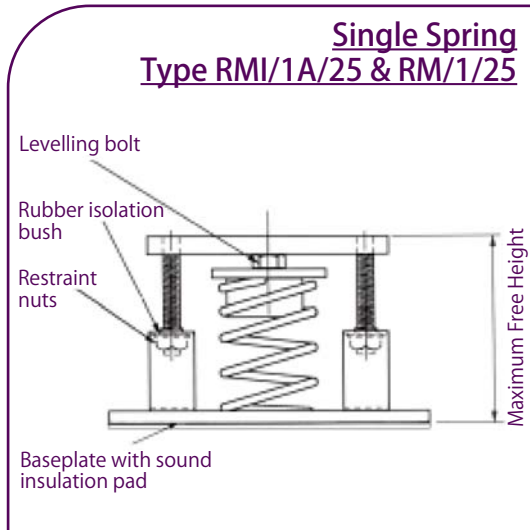
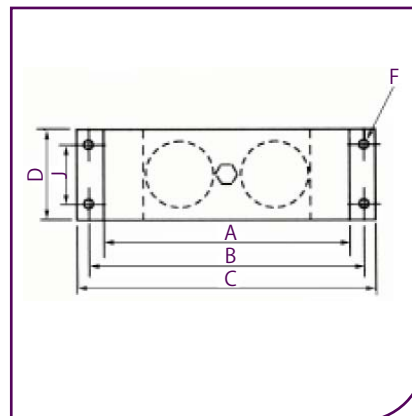
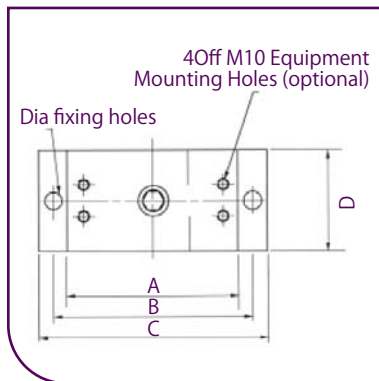

The supported equipment is positioned on the top load plate. Mounting holes can be predrilled in the top plate if requested. The mounts may be fixed down utilising the pre-drilled holes in the base plate. Alternatively, the neoprene pad will act as a friction pad.

<b>Dimensional Data</b> mm								<b>Load Range</b> Kg	<b>Nom Defl</b> mm
<b>Type</b>	<b>A</b>	<b>B</b>	<b>C</b>	<b>D</b>	<b>E</b>	<b>F</b>	<b>G</b>		
<b>RMI/1A/25</b>	165	190	230	90	-	14	145	11-500	25
<b>RMI/1/25</b>	190	220	250	90	-	14	195	97-1091	25
<b>RMI/2/25</b>	330	370	410	130	70	14	205	193-2182	25
<b>RMI/1/50</b>	190	220	250	90	-	14	230	50-2000	50
<b>RMI/1/75</b>	210	240	280	130	-	14	260	50-2000	75
<b>RMI/1/100</b>	330	358	408	200	-	14	425	100-3000	100